

REBUILT EQUIPMENT

Baffles & Traps

BAFFLES & TRAPS

MFG	ANSI	DESCRIPTION	TYPE	PRICE
CVC	2	BCR-21A Alum Chevron, Ambient	Baffle	\$120.00
CVC	2	BC-21 Multi-Coolant	Trap	480.00
Varian	2	Conduction-Cooled Inlet Baffle	Baffle	180.00
Varian	2	M-2, 332 Model Water Baffle	Baffle	400.00
Varian	2	325 LN ₂	Trap	999.00
CPA	4	Long Life	Trap	1350.00
CVC	4	BCR-41A, Alum, Chevron, Ambient	Baffle	250.00
CVC	4	BCRW-41A, Alum, chevron, H ₂ O-cooled	Baffle	560.00
CVC	4	BC-41, Multi-Coolant	Trap	600.00
CVC	4	BNC-41, LN ₂	Trap	900.00
Varian	4	316-4, LN ₂	Trap	500.00
Varian	4	334 M4 Water Baffle	Baffle	900.00
Varian	4	362-4, Long Life	Trap	1800.00
CPA	6	Long Life	Trap	1350.00
CVC	6	BC-61 Multi-Coolant	Trap	1000.00
CVC	6	BCN-61, LN ₂	Trap	1300.00
CVC	6	BCR-61 Alum, Chevron, Ambient	Baffle	300.00
CVC	6	BCRW-61 Alum, Chevron, H ₂ O-cooled	Baffle	1000.00
GP	6	SST Model 224	Trap	1500.00
GP	6	SST Model 278	Trap	1800.00
Varian	6	316-6 LN ₂	Trap	1000.00
Varian	6	Model 336, Water Baffle	Baffle	1100.00
Varian	6	951-5212, Trap/Valve Combination	Combo	3700.00
Varian	6	326-6 LN ₂ Drawer Design	Trap	2000.00
Varian	6	362-6 LN ₂	Trap	2200.00
CVC	10	Chevron Baffle, H ₂ O-cooled	Baffle	1300.00
CVC	10	BC-101 Multi-Coolant	Trap	1800.00
Varian	10	316-10 Type with LN ₂	Trap	4500.00
Varian	10	326 Type, Drawer Design with LN ₂ & H ₂ O	Combo	4000.00

ANSI/ASA REFERENCE

ANSI/ASA	OD	BCD	# OF BOLTS
2 lt. weight	4.00"	3.312"	6
2	6.00"	4.750"	4
4	9.00"	7.500"	8
6	11.00"	9.500"	8
10	16.00"	14.250"	12
16	23.50"	21.250"	16
20	27.50"	25.00"	20

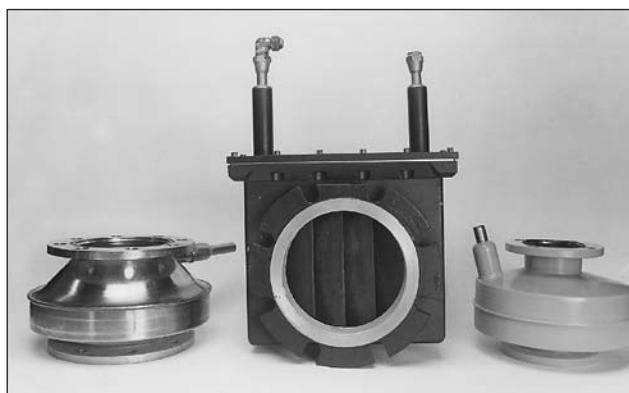
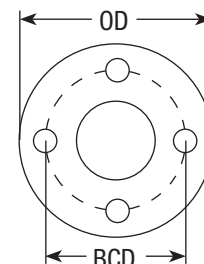

Varian 316-4

CVC BC-61

Varian 325

AUTOMATIC SEQUENCERS

MFG	MODEL	DESCRIPTION	PRICE
NRC	NRC-703	Operates 4 valves with signal for TC Tube 531	\$1200.00
Varian	971-1015	Same as NRC-703	1200.00
Varian	971-1016	DP System Valve Control	1200.00
Varian	980-6100	Cryo Pump System Valve Control	1000.00
Comptech	--	For Cryopump System	600.00

Rebuilt equipment is completely reconditioned and comes with our standard 90-day warranty. Rebuilt items are subject to availability. Please call for stock.

MECHANICAL
PUMPS