

HARDWARE

Conflat® - Style Flanges

HARDWARE

Duniway Stockroom Corp. supplies a wide range of Conflat-style hardware, including: fixed flanges, rotatable flanges, fittings, gaskets and fasteners. Conflat flanges are the industry standard for high and ultrahigh vacuum applications. The unique design captures a **FLAT** copper gasket between two symmetrical, outward sloping, **CON**ical stainless steel knife-edges on identical mating flanges. (Thus the name Conflat) As the knife edges are pushed together during tightening of the flange, the copper gasket is constrained from outward flow by the inner diameter of the flange face. (see sketch) This design gives reliable, all-metal, leak-free seals over a wide range of temperatures (cryogenic to 450°C).

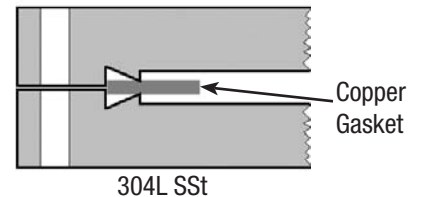

DIMENSIONS

ISO	PART # PREFIX	OD	BCD	THICKNESS A	# OF BOLTS
NW16	133-	1.33"	1.062"	.300"	6
NW25	218-	2.125"	1.625"	.470"	4
NW35	275-	2.75"	2.312"	.500"	6
NW50	338-	3.375"	2.850"	.625"	8
NW63	450-	4.50"	3.628"	.680"	8
NW75	458-	4.625"	4.030"	.750"	10
NW100	600-	6.00"	5.128"	.780"	16
NW130	675-	6.75"	5.969"	.840"	18
NW150	800-	8.00"	7.128"	.880"	20
NW200	1000-	10.00"	9.128"	.970"	24
NW250	1200-	12.00"	11.100"	1.02"	32
NW275	1325-	13.25"	12.060"	1.12"	30

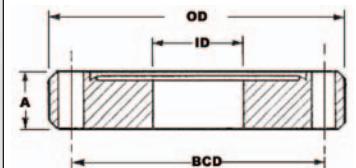

NOTE: FOR SIZES NOT SHOWN, PLEASE REQUEST A QUOTE.

CF FLANGES 1 1/3" OD

DUNIWAY PART #	DESCRIPTION	PRICE
F133-000N	CF Flange, 1.33" OD, Blank, Non-Rotatable	\$14.00
F133-000NT	CF Flange, 1.33" OD, Blank, Non-Rotatable-Tapped	19.50
F133-000R	CF Flange, 1.33" OD, Blank, Rotatable	16.00
F133-000RT	CF Flange, 1.33" OD, Blank, Rotatable-Tapped	21.00
F133-038N	CF Flange, 1.33" OD, 0.375" ID, Non-Rotatable	14.00
F133-038NT	CF Flange, 1.33" OD, 0.375" ID, Non-Rotatable-Tapped	19.50
F133-038R	CF Flange, 1.33" OD, 0.375" ID, Rotatable	16.00
F133-038RT	CF Flange, 1.33" OD, 0.375" ID, Rotatable-Tapped	21.00
F133-050N	CF Flange, 1.33" OD, 0.50" ID, Non-Rotatable	14.00
F133-050NT	CF Flange, 1.33" OD, 0.50" ID, Non-Rotatable-Tapped	19.50
F133-050R	CF Flange, 1.33" OD, 0.50" ID, Rotatable	16.00
F133-050RT	CF Flange, 1.33" OD, 0.50" ID, Rotatable-Tapped	21.00
F133-075N	CF Flange, 1.33" OD, 0.75" ID, Non-Rotatable	14.00
F133-075NT	CF Flange, 1.33" OD, 0.75" ID, Non-Rotatable-Tapped	19.50
F133-075R	CF Flange, 1.33" OD, 0.75" ID, Rotatable	16.00
F133-075RT	CF Flange, 1.33" OD, 0.75" ID, Rotatable-Tapped	21.00

HARDWARE

Conflat® - Style Flanges

HARDWARE

CF FLANGES 2 1/8" OD

DUNIWAY PART #	DESCRIPTION	PRICE
F218-000N	CF Flange, 2.18" OD, Blank, Non-Rotatable	\$17.00
F218-000T	CF Flange, 2.18" OD, Blank, Non-Rotatable-Tapped	22.00
F218-000R	CF Flange, 2.18" OD, Blank, Rotatable	21.00
F218-000RT	CF Flange, 2.18" OD, Blank, Rotatable-Tapped	24.50
F218-100N	CF Flange, 2.18" OD, 1.00" ID, Non-Rotatable	17.00
F218-100T	CF Flange, 2.18" OD, 1.00" ID, Non-Rotatable-Tapped	22.00
F218-100R	CF Flange, 2.18" OD, 1.00" ID, Rotatable	21.00
F218-100RT	CF Flange, 2.18" OD, 1.00" ID, Rotatable-Tapped	24.50

CF FLANGES 2 3/4" OD

DUNIWAY PART #	DESCRIPTION	PRICE
F275-000N	CF Flange, 2.75" OD, Blank, Non-Rotatable	\$16.00
F275-000T	CF Flange, 2.75" OD, Blank, Non-Rotatable-Tapped	24.00
F275-000R	CF Flange, 2.75" OD, Blank, Rotatable	24.00
F275-000RT	CF Flange, 2.75" OD, Blank, Rotatable-Tapped	31.00
F275-050N	CF Flange, 2.75" OD, 0.50" ID, Non-Rotatable	16.00
F275-050T	CF Flange, 2.75" OD, 0.50" ID, Non-Rotatable-Tapped	24.00
F275-050R	CF Flange, 2.75" OD, 0.50" ID, Rotatable	24.00
F275-050RT	CF Flange, 2.75" OD, 0.50" ID, Rotatable-Tapped	31.00
F275-075N	CF Flange, 2.75" OD, 0.75" ID, Non-Rotatable	16.00
F275-075T	CF Flange, 2.75" OD, 0.75" ID, Non-Rotatable-Tapped	24.00
F275-075R	CF Flange, 2.75" OD, 0.75" ID, Rotatable	24.00
F275-075RT	CF Flange, 2.75" OD, 0.75" ID, Rotatable-Tapped	31.00
F275-100N	CF Flange, 2.75" OD, 1.00" ID, Non-Rotatable	16.00
F275-100T	CF Flange, 2.75" OD, 1.00" ID, Non-Rotatable-Tapped	24.00
F275-100R	CF Flange, 2.75" OD, 1.00" ID, Rotatable	24.00
F275-100RT	CF Flange, 2.75" OD, 1.00" ID, Rotatable-Tapped	31.00
F275-150N	CF Flange, 2.75" OD, 1.50" ID, Non-Rotatable	16.00
F275-150T	CF Flange, 2.75" OD, 1.50" ID, Non-Rotatable-Tapped	24.00
F275-150R	CF Flange, 2.75" OD, 1.50" ID, Rotatable	24.00
F275-150RT	CF Flange, 2.75" OD, 1.50" ID, Rotatable-Tapped	31.00

CF FLANGES 3 3/8" OD

DUNIWAY PART #	DESCRIPTION	PRICE
F338-000N	CF Flange, 3.375" OD, Blank, Non-Rotatable	\$40.00
F338-000T	CF Flange, 3.375" OD, Blank, Non-Rotatable-Tapped	49.00
F338-000R	CF Flange, 3.375" OD, Blank, Rotatable	45.00
F338-000RT	CF Flange, 3.375" OD, Blank, Rotatable-Tapped	54.00
F338-200N	CF Flange, 3.375" OD, 2.00" ID, Non-Rotatable	40.00
F338-200T	CF Flange, 3.375" OD, 2.00" ID, Non-Rotatable-Tapped	49.00
F338-200R	CF Flange, 3.375" OD, 2.00" ID, Rotatable	45.00
F338-200RT	CF Flange, 3.375" OD, 2.00" ID, Rotatable-Tapped	54.00

HARDWARE

Conflat® - Style Flanges

HARDWARE

CF FLANGES 4 1/2" OD

DUNIWAY PART #	DESCRIPTION	PRICE
F450-000N	CF Flange, 4.50" OD, Blank, Non-Rotatable	\$58.00
F450-000NT	CF Flange, 4.50" OD, Blank, Non-Rotatable-Tapped	67.00
F450-000R	CF Flange, 4.50" OD, Blank, Rotatable	67.00
F450-000RT	CF Flange, 4.50" OD, Blank, Rotatable-Tapped	77.00
F450-250N	CF Flange, 4.50" OD, 2.50" ID, Non-Rotatable	58.00
F450-250NT	CF Flange, 4.50" OD, 2.50" ID, Non-Rotatable-Tapped	67.00
F450-250R	CF Flange, 4.50" OD, 2.50" ID, Rotatable	67.00
F450-250RT	CF Flange, 4.50" OD, 2.50" ID, Rotatable-Tapped	77.00

CF FLANGES 4 5/8" OD

DUNIWAY PART #	DESCRIPTION	PRICE
F458-000N	CF Flange, 4.625" OD, Blank, Non-Rotatable	\$64.00
F458-000NT	CF Flange, 4.625" OD, Blank, Non-Rotatable-Tapped	76.00
F458-000R	CF Flange, 4.625" OD, Blank, Rotatable	74.00
F458-000RT	CF Flange, 4.625" OD, Blank, Rotatable-Tapped	85.00
F458-300N	CF Flange, 4.625" OD, 3.00" ID, Non-Rotatable	64.00
F458-300NT	CF Flange, 4.625" OD, 3.00" ID, Non-Rotatable-Tapped	76.00
F458-300R	CF Flange, 4.625" OD, 3.00" ID, Rotatable	74.00
F458-300RT	CF Flange, 4.625" OD, 3.00" ID, Rotatable-Tapped	85.00

CF FLANGES 6" OD

DUNIWAY PART #	DESCRIPTION	PRICE
F600-000N	CF Flange, 6.00" OD, Blank, Non-Rotatable	\$87.00
F600-000NT	CF Flange, 6.00" OD, Blank, Non-Rotatable-Tapped	115.00
F600-000R	CF Flange, 6.00" OD, Blank, Rotatable	109.00
F600-000RT	CF Flange, 6.00" OD, Blank, Rotatable-Tapped	125.00
F600-400N	CF Flange, 6.00" OD, 4.00" ID, Non-Rotatable	87.00
F600-400NT	CF Flange, 6.00" OD, 4.00" ID, Non-Rotatable-Tapped	115.00
F600-400R	CF Flange, 6.00" OD, 4.00" ID, Rotatable	109.00
F600-400RT	CF Flange, 6.00" OD, 4.00" ID, Rotatable-Tapped	125.00



HARDWARE

Conflat® - Style Flanges

HARDWARE

CF FLANGES 6³/₄" OD

DUNIWAY PART #	DESCRIPTION	PRICE
F675-000N	CF Flange, 6.75" OD, Blank, Non-Rotatable	\$105.00
F675-000NT	CF Flange, 6.75" OD, Blank, Non-Rotatable-Tapped	126.00
F675-000R	CF Flange, 6.75" OD, Blank, Rotatable	120.00
F675-000RT	CF Flange, 6.75" OD, Blank, Rotatable-Tapped	133.00
F675-400N	CF Flange, 6.75" OD, 4.00" ID, Non-Rotatable	105.00
F675-400NT	CF Flange, 6.75" OD, 4.00" ID, Non-Rotatable-Tapped	126.00
F675-400R	CF Flange, 6.75" OD, 4.00" ID, Rotatable	120.00
F675-400RT	CF Flange, 6.75" OD, 4.00" ID, Rotatable-Tapped	133.00
F675-500N	CF Flange, 6.75" OD, 5.00" ID, Non-Rotatable	105.00
F675-500NT	CF Flange, 6.75" OD, 5.00" ID, Non-Rotatable-Tapped	126.00
F675-500R	CF Flange, 6.75" OD, 5.00" ID, Rotatable	120.00
F675-500RT	CF Flange, 6.75" OD, 5.00" ID, Rotatable-Tapped	133.00

CF FLANGES 8" OD

DUNIWAY PART #	DESCRIPTION	PRICE
F800-000N	CF Flange, 8.00" OD, Blank, Non-Rotatable	\$158.00
F800-000NT	CF Flange, 8.00" OD, Blank, Non-Rotatable-Tapped	189.00
F800-000R	CF Flange, 8.00" OD, Blank, Rotatable	180.00
F800-000RT	CF Flange, 8.00" OD, Blank, Rotatable-Tapped	220.00
F800-600N	CF Flange, 8.00" OD, 6.00" ID, Non-Rotatable	158.00
F800-600NT	CF Flange, 8.00" OD, 6.00" ID, Non-Rotatable-Tapped	189.00
F800-600R	CF Flange, 8.00" OD, 6.00" ID, Rotatable	180.00
F800-600RT	CF Flange, 8.00" OD, 6.00" ID, Rotatable-Tapped	220.00

CF FLANGES ≥10" OD

DESCRIPTION	PRICE
CF Flanges 10" OD	Inquire
CF Flanges 12" OD	Inquire
CF Flanges 13 ¹ / ₄ " OD	Inquire