

# HARDWARE

## Conflat - Type Fittings

HARDWARE

### HALF NIPPLES

DUNIWAY PART #	FLANGE OD	LENGTH A	TUBE OD	PRICE
HN-133	1.33"	1.5"	0.75"	\$31.00
HN-218	2.125"	2.0"	1.00"	35.00
HN-275	2.75"	2.5"	1.50"	39.00
HN-338	3.375"	3.2"	2.00"	81.00
HN-450	4.50"	4.1"	2.50"	115.00
HN-458	4.625"	3.5"	3.00"	145.00
HN-600	6.00"	5.3"	4.00"	170.00
HN-675	6.75"	4.9"	5.00"	188.00
HN-800	8.00"	6.6"	6.00"	303.00
HN-1000	10.00"	8.0"	8.00"	428.00

"A" Dimensions may vary from lot-to-lot. Contact your customer representative if your application requires exact dimensions.

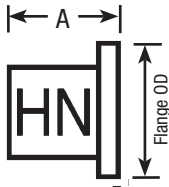

Non-Rotatable

### TEES

DUNIWAY PART #	FLANGE OD	LENGTH A	TUBE OD	PRICE
TE-133	1.33"	1.5"	0.75"	\$86.00
TE-218	2.125"	2.0"	1.00"	96.00
TE-275	2.75"	2.5"	1.50"	107.00
TE-338	3.375"	3.2"	2.00"	245.00
TE-450	4.50"	3.4"	2.50"	301.00
TE-458	4.625"	3.6"	3.00"	380.00
TE-600	6.00"	4.3"	4.00"	440.00
TE-675	6.75"	4.9"	5.00"	720.00
TE-800	8.00"	6.1"	6.00"	830.00
TE-1000	10.00"	7.5"	8.00"	1400.00

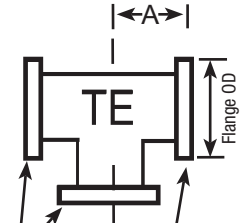

Rotatable  
Non-Rotatable

### NIPPLES

DUNIWAY PART #	FLANGE OD	LENGTH A	TUBE OD	PRICE
NP-133	1.33"	3.0"	0.75"	\$50.00
NP-218	2.125"	4.1"	1.00"	65.00
NP-275	2.75"	4.9"	1.50"	61.00
NP-338	3.375"	6.4"	2.00"	160.00
NP-450	4.50"	8.2"	2.50"	212.00
NP-458	4.625"	7.1"	3.00"	260.00
NP-600	6.00"	10.6"	4.00"	280.00
NP-675	6.75"	9.9"	5.00"	407.00
NP-800	8.00"	13.1"	6.00"	439.00
NP-1000	10.00"	16.0"	8.00"	846.00

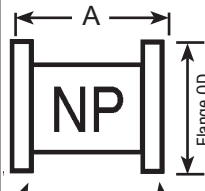

Rotatable  
Non-Rotatable

### CROSSES

DUNIWAY PART #	FLANGE OD	LENGTH A	TUBE OD	PRICE
CR-133	1.33"	1.5"	0.75"	\$115.00
CR-218	2.125"	2.0"	1.00"	139.00
CR-275	2.75"	2.5"	1.50"	145.00
CR-338	3.375"	3.2"	2.00"	329.00
CR-450	4.50"	3.4"	2.50"	399.00
CR-458	4.625"	3.6"	3.00"	550.00
CR-600	6.00"	5.3"	4.00"	660.00
CR-675	6.75"	4.9"	5.00"	1080.00
CR-800	8.00"	6.1"	6.00"	1350.00
CR-1000	10.00"	8.0"	8.00"	POR*

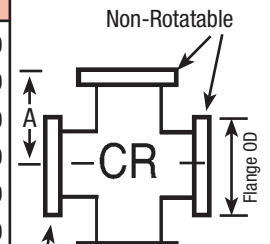

Non-Rotatable  
Rotatable

### ELBOWS

DUNIWAY PART #	FLANGE OD	LENGTH A	TUBE OD	PRICE
EL-133	1.33"	1.6"	0.75"	\$62.00
EL-218	2.125"	1.7"	1.00"	73.00
EL-275	2.75"	2.5"	1.50"	69.00
EL-338	3.375"	3.2"	2.00"	180.00
EL-450	4.50"	4.1"	2.50"	275.00
EL-458	4.625"	4.9"	3.00"	330.00
EL-600	6.00"	6.5"	4.00"	327.00
EL-675M	6.75"	4.9"	5.00"	463.00
EL-800M	8.00"	6.6"	6.00"	538.00
EL-1000M	10.00"	8.0"	8.00"	975.00

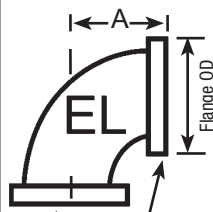

Rotatable  
Rotatable

### FLEX COUPLINGS

DUNIWAY PART #	FLANGE OD	LENGTH A	TUBE OD	PRICE
FX-133	1.33"	3.00"	0.75"	\$85.00
FX-133-10	1.33"	10.00"	0.75"	97.00
FX-218	2.125"	3.44"	1.00"	POR*
FX-275	2.75"	3.60"	1.50"	105.00
FX-338	3.375"	4.00"	2.00"	205.00
FX-450	4.50"	6.25"	2.50"	310.00
FX-458	4.625"	7.00"	3.00"	POR*
FX-600	6.00"	7.62"	4.00"	POR*
FX-675	6.75"	7.00"	5.00"	POR*
FX-800	8.00"	6.00"	6.00"	POR*
FX-1000	10.00"	7.00"	8.00"	POR*

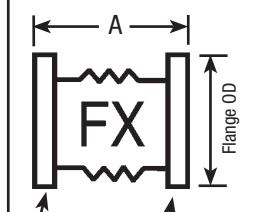

Rotatable  
Non-Rotatable

\* Price on Request

Items shaded have 90° Mitered Elbows as opposed to 90° Radius (pictured) Elbows.

See Page 12 for Gaskets  
See Page 13- 14 for Nuts & Bolts