

HARDWARE

KF fittings, Qwik Flanges

HARDWARE

- 304 Stainless Steel
- Some parts also available in Aluminum or Brass
- Dupont® Dow Certified

DIMENSIONS	
KF16/30mm	Tube OD: 3/4", Flange OD: 1.18"
KF25/40mm	Tube OD: 1", Flange OD: 1.57"
KF40/55mm	Tube OD: 1-1/2", Flange OD: 2.16"
KF50/75mm	Tube OD: 2", Flange OD: 2.95"

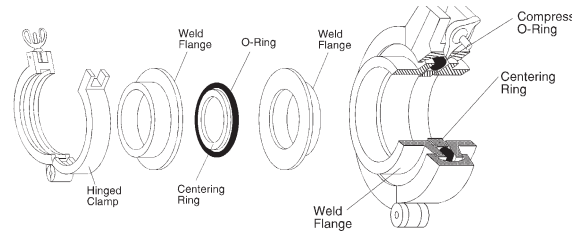

KF FITTINGS, QWIK FLANGES

DUNIWAY PART #	DESCRIPTION	PRICE	SKETCH #
KF16-CP	KF16 Clamp, Aluminum, With Wing Nut	\$5.00	1
KF25-CP	KF25 Clamp, Aluminum, With Wing Nut	7.00	1
KF40-CP	KF40 Clamp, Aluminum, With Wing Nut	8.00	1
KF50-CP	KF50 Clamp, Aluminum, With Wing Nut	14.00	1
KF10-CR	KF10 Centering Ring, With Viton™ O-Ring	5.50	2
KF16-CR	KF16 Centering Ring, With Viton™ O-Ring	5.00	2
KF25-CR	KF25 Centering Ring, With Viton™ O-Ring	7.00	2
KF40-CR	KF40 Centering Ring, With Viton™ O-Ring	9.00	2
KF50-CR	KF50 Centering Ring, With Viton™ O-Ring	12.00	2
KF16-OV	KF16 Viton™ O-Ring, Replacement	2.00	3
KF25-OV	KF25 Viton™ O-Ring, Replacement	2.00	3
KF40-OV	KF40 Viton™ O-Ring, Replacement	3.00	3
KF50-OV	KF50 Viton™ O-Ring, Replacement	4.00	3
KF10-FB	KF10 Flange, Blank	7.00	4
KF16-FB	KF16 Flange, Blank	7.00	4
KF25-FB	KF25 Flange, Blank	8.00	4
KF40-FB	KF40 Flange, Blank	12.50	4
KF50-FB	KF50 Flange, Blank	16.00	4
KF16-075	KF16 Flange, 0.75" Socket Weld	8.00	5
KF16-075B	KF16 Flange, 0.75" Socket Weld, Brass	10.50	5
KF25-100	KF25 Flange, 1.00" Socket Weld	9.00	5
KF25-100B	KF25 Flange, 1.00" Socket Weld, Brass	11.80	5
KF40-150	KF40 Flange, 1.50" Socket Weld	12.50	5
KF40-150B	KF40 Flange, 1.50" Socket Weld, Brass	16.50	5
KF50-200	KF50 Flange, 2.00" Socket Weld	18.00	5
KF50-200B	KF50 Flange, 2.00" Socket Weld, Brass	25.00	5
KF25-075	KF25 Flange, Weld Reducer, 0.75"	9.00	6
KF25-050	KF25 Flange, Weld Reducer, 0.50"	9.00	6
KF40-100	KF40 Flange, Weld Reducer, 1.00"	12.50	6
KF40-075	KF40 Flange, Weld Reducer, 0.75"	12.50	6
KF40-050	KF40 Flange, Weld Reducer, 0.50"	12.50	6
KF50-150	KF50 Flange, Weld Reducer, 1.50"	18.00	6
KF50-100	KF50 Flange, Weld Reducer, 1.00"	18.00	6
KF50-075	KF50 Flange, Weld Reducer, 0.75"	18.00	6
KF16-S0	KF16 Flange, Stub, Blank	11.25	7
KF25-S0	KF25 Flange, Stub, Blank	12.50	7
KF40-S0	KF40 Flange, Stub, Blank	17.50	7
KF50-S0	KF50 Flange, Stub, Blank	26.00	7
KF16-1/8	KF16 Flange, Stub, 1/8" NPT	24.00	8
KF16-1/4	KF16 Flange, Stub, 1/4" NPT	24.00	8
KF25-1/8	KF25 Flange, Stub, 1/8" NPT	27.00	8
KF25-1/4	KF25 Flange, Stub, 1/4" NPT	27.00	8
KF25-3/4M	KF25 Flange, Stub, 3/4" Male	67.00	-
KF40-1/8	KF40 Flange, Stub, 1/8" NPT	31.00	8
KF40-1/4	KF40 Flange, Stub, 1/4" NPT	31.00	8
KF50-1/8	KF50 Flange, Stub, 1/8" NPT	40.00	8
KF50-1/4	KF50 Flange, Stub, 1/4" NPT	40.00	8

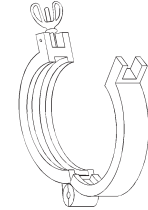

1

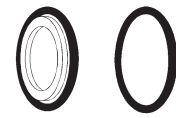

2

3



4

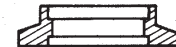

5

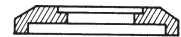

6



7



8

HARDWARE

KF fittings, Qwik Flanges

HARDWARE

KF FITTINGS, QWIK FLANGES			
DUNIWAY PART #	DESCRIPTION	PRICE	SKETCH #
KF16-133	KF16 Flange To Conflat® 1.33" OD	\$52.00	10
KF25-275	KF25 Flange To Conflat® 2.75" OD	66.00	10
KF40-275	KF40 Flange To Conflat® 2.75" OD	66.00	10
KF50-450	KF50 Flange To Conflat® 4.50" OD	136.00	10
KF25-CP50	KF25 Flange To 1/2" Compression Port	63.00	11
KF40-CP50	KF40 Flange To 1/2" Compression Port	68.00	11
KF16-CP75	KF16 Flange To 3/4" Compression Port	73.00	11
KF25-CP75	KF25 Flange To 3/4" Compression Port	68.00	11
KF40-CP75	KF40 Flange To 3/4" Compression Port	72.00	11
KF50-CP75	KF50 Flange To 3/4" Compression Port	91.00	11
KF25-CP100	KF25 Flange To 1.0" Compression Port	85.00	11
KF40-CP100	KF40 Flange To 1.0" Compression Port	90.00	11
KF50-CP100	KF50 Flange To 1.0" Compression Port	95.00	11
KF25-CP118	KF25 Flange To 1 1/8" Compression Port	96.00	11
KF40-CP118	KF40 Flange To 1 1/8" Compression Port	120.00	11
KF50-CP118	KF50 Flange To 1 1/8" Compression Port	155.00	11
KF16-1400	KF16 Flange To Welch 1400 Pump Inlet	75.00	12
KF25-1402	KF25 Flange to Welch 1402 Pump Intake or Exhaust, Model 1376 Exhaust Only	80.00	12
KF40-1397	KF40 Flange to Welch 1397 or 1374 Pump Intake or Exhaust	105.00	12
KF16-HA	KF16 Flange To Hose (5/8" or 3/4" ID) Adaptor, Aluminum	11.00	13
KF25-HA	KF25 Flange To Hose (3/4" or 13/16" ID) Adaptor, Aluminum	13.00	13
KF40-HA	KF40 Flange To Hose (1 1/2" or 1 5/8" ID) Adaptor, Aluminum	17.00	13
KF50-HA	KF50 Flange To Hose (1 1/2" or 1 5/8" ID) Adaptor, Aluminum	23.00	13
KF25-TP118	KF25 Flange To Leak Detector Port	55.00	14
KF40-TP118	KF40 Flange To Leak Detector Port	65.00	14
KF16-HN	KF16 Flange , Half Nipple	12.50	15
KF25-HN	KF25 Flange , Half Nipple	15.00	15
KF40-HN	KF40 Flange , Half Nipple	17.00	15
KF50-HN	KF50 Flange , Half Nipple	25.00	15
KF16-NP	KF16 Flange , Nipple	37.00	16
KF25-NP	KF25 Flange , Nipple	42.00	16
KF40-NP	KF40 Flange , Nipple	53.00	16
KF50-NP	KF50 Flange , Nipple	65.00	16
KF25-NR16	KF25 Flange, Reducing Nipple To KF16	34.00	17
KF40-NR16	KF40 Flange, Reducing Nipple To KF16	38.00	17
KF40-NR25	KF40 Flange, Reducing Nipple To KF25	38.00	17
KF50-NR16	KF50 Flange, Reducing Nipple To KF16	40.00	17
KF50-NR25	KF50 Flange, Reducing Nipple To KF25	45.00	17
KF50-NR40	KF50 Flange, Reducing Nipple To KF40	45.00	17
KF16-EL45	KF16 Flange, 45 Degree Elbow	45.00	18
KF25-EL45	KF25 Flange, 45 Degree Elbow	50.00	18
KF40-EL45	KF40 Flange, 45 Degree Elbow	78.00	18
KF50-EL45	KF50 Flange, 45 Degree Elbow	88.00	18
KF16-EL90	KF16 Flange, 90 Degree Elbow	42.00	19
KF25-EL90	KF25 Flange, 90 Degree Elbow	46.00	19
KF40-EL90	KF40 Flange, 90 Degree Elbow	64.00	19
KF50-EL90	KF50 Flange, 90 Degree Elbow	83.00	19

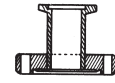

10



11

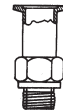

12

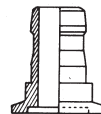

13

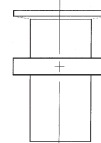

14

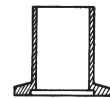

15

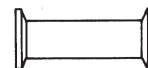

16

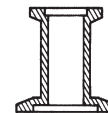

17



18

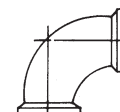

19

HARDWARE

KF fittings, Qwik Flanges

HARDWARE

KF FITTINGS, QWIK FLANGES

DUNIWAY PART #	DESCRIPTION	PRICE	SKETCH #
KF16-TE	KF16 Flange, Tee	\$61.00	20
KF25-TE	KF25 Flange, Tee	70.00	20
KF40-TE	KF40 Flange, Tee	79.00	20
KF50-TE	KF50 Flange, Tee	115.00	20
KF16-CS	KF16 Flange, Cross	90.00	21
KF25-CS	KF25 Flange, Cross	105.00	21
KF40-CS	KF40 Flange, Cross	135.00	21
KF50-CS	KF50 Flange, Cross	180.00	21
KF16-FX4	KF 16 Flange, Flex Coupling, 4" Long	85.00	22
KF16-FX10	KF 16 Flange, Flex Coupling, 10" Long	85.00	22
KF16-FX20	KF 16 Flange, Flex Coupling, 20" Long	103.00	22
KF16-FX40	KF 16 Flange, Flex Coupling, 40" Long	152.00	22
KF25-FX4	KF 25 Flange, Flex Coupling, 4" Long	75.00	22
KF25-FX10	KF 25 Flange, Flex Coupling, 10" Long	89.00	22
KF25-FX20	KF 25 Flange, Flex Coupling, 20" Long	110.00	22
KF25-FX40	KF 25 Flange, Flex Coupling, 40" Long	158.00	22
KF40-FX4	KF 40 Flange, Flex Coupling, 4" Long	82.00	22
KF40-FX10	KF 40 Flange, Flex Coupling, 10" Long	115.00	22
KF40-FX20	KF 40 Flange, Flex Coupling, 20" Long	140.00	22
KF40-FX40	KF 40 Flange, Flex Coupling, 40" Long	200.00	22
KF50-FX4	KF 50 Flange, Flex Coupling, 4" Long	85.00	22
KF50-FX10	KF 50 Flange, Flex Coupling, 10" Long	152.00	22
KF50-FX20	KF 50 Flange, Flex Coupling, 20" Long	165.00	22
KF50-FX40	KF 50 Flange, Flex Coupling, 40" Long	215.00	22
KF16-10-CR	Adaptive KF Centering Ring, KF16 To KF10, O-Ring Included	10.00	
KF25-20-CR	Adaptive KF Centering Ring, KF25 To KF20, O-Ring Included	11.00	
KF40-32-CR	Adaptive KF Centering Ring, KF40 To KF32, O-Ring Included	13.00	

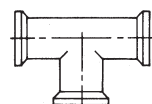

20

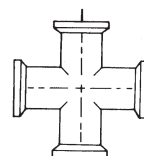

21



22